

CODICE DI ORDINAZIONE / ORDERING CODE

## 20 BPC XXX X X X 0 0 0

0 = SINGOLA / SINGLE

ACCESSORI / ACCESSORIES  
0 = NESSUNO / NONE

VARIANTI / VARIANTS  
0 = NESSUNA / NONE

GUARNIZIONI E GIUNTI / GASKETS AND COUPLINGS  
0 = NBR (standard)  
3 = MANICOTTO + VITI (PER ALBERO FRESATO CON DENTE FRONTALE)  
SLEEVE + SCREWS (FOR DIHEDRAL CLAW SHAFT)

H = HNBR (a richiesta / on request)  
V = VITON (a richiesta / on request)

ALBERO / SHAFT  
2 = SCANALATO SAE 9T / SPLINED SAE 9 T  
3 = FRESATO CON DENTE FRONTALE (CON GIUNTO E VITI)  
DIHEDRAL CLAW (WITH COUPLING AND SCREWS)

ROTAZIONE / ROTATION  
D = DESTRA / CLOCKWISE  
S = SINISTRA / ANTICLOCKWISE

CILINDRATA / DISPLACEMENT

TIPO / TYPE

POMPA AD INGRANAGGI / GEAR PUMP



**MONODIREZIONALE  
MONO-ROTATIONAL**



**BPC 08**

**BPC 13**

**BPC 22**

**BPC 11**

**BPC 16**

**BPC 25**

GIUNTO / COUPLING CODICE / CODE 1170353600000

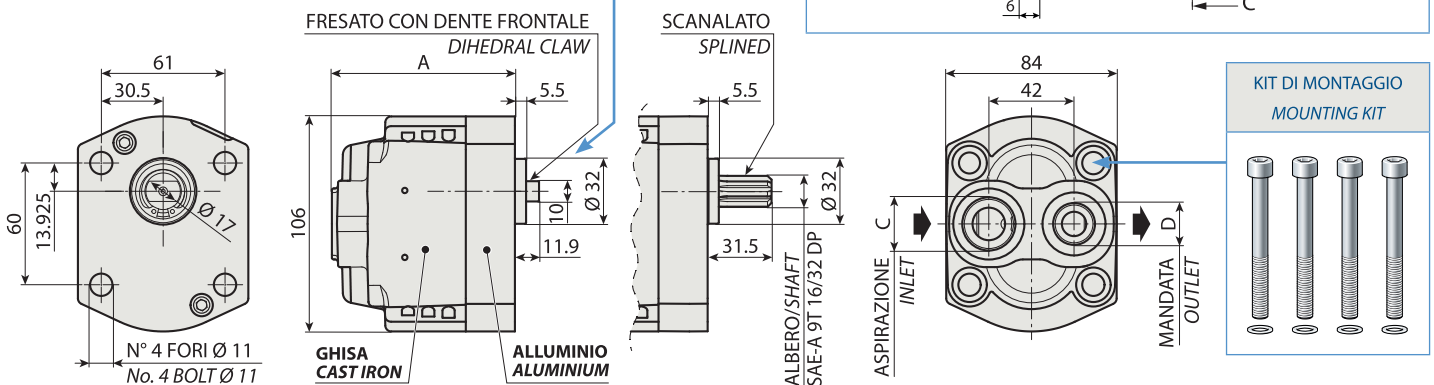
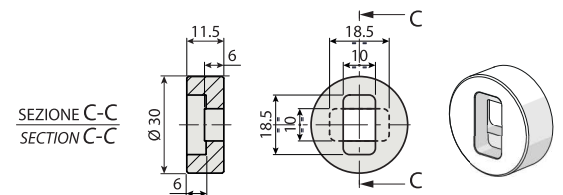

### CARATTERISTICHE E DATI TECNICI / SPECIFICATIONS AND TECHNICAL DATA

TIPO TYPE	CODICE / CODE		CILINDRATA DISPLACEMENT cm <sup>3</sup> /rev.	A mm	C ASPIRAZIONE INLET	D MANDATA OUTLET	PESO WEIGHT kg	KIT DI MONTAGGIO MOUNTING KIT
	ROTAZIONE DESTRA CLOCKWISE ROT.	ROTAZIONE SINISTRA ANTICLOCKWISE ROT.						
<b>BPC 08</b>	<b>20BPC008DXX000</b>	<b>20BPC008SXX000</b>	8.3	79.9	3/4" G	1/2" G	2.6	205H1230000000
<b>BPC 11</b>	<b>20BPC011DXX000</b>	<b>20BPC011SXX000</b>	11.5	85.1	3/4" G	1/2" G	2.8	205H1231000000
<b>BPC 13</b>	<b>20BPC013DXX000</b>	<b>20BPC013SXX000</b>	13.5	90.2	3/4" G	1/2" G	3.2	20579300000000
<b>BPC 16</b>	<b>20BPC016DXX000</b>	<b>20BPC016SXX000</b>	16.4	94.6	3/4" G	1/2" G	3.4	205H1232000000
<b>BPC 22</b>	<b>20BPC022DXX000</b>	<b>20BPC022SXX000</b>	20.5	101.0	3/4" G	1/2" G	3.8	205H1233000000
<b>BPC 25</b>	<b>20BPC025DXX000</b>	<b>20BPC025SXX000</b>	25.3	104.6	3/4" G	1/2" G	4.0	205H1234000000

KIT RASAMENTI / THRUST PLATES KIT COD. 20602800000000 - KIT GUARNIZIONI COMPLETO NBR (standard) / COMPLETE SEALS KIT NBR (standard) COD. 21904600000000

Per la scelta dei raccordi orientabili vedi pag. <?>-<?> / For the selection of adjustable fittings see page <?>-<?>

TIPO / TYPE			BPC 08	BPC 11	BPC 13	BPC 16	BPC 22	BPC 25
Cilindrata <i>Displacement</i>	Vg	cm <sup>3</sup> /n cm <sup>3</sup> /rev.	8.3	11.5	13.5	16.4	20.5	25.3
Pressione massima continua <i>Max continuous operating pressure</i>	P1	bar	280	280	280	280	260	240
Pressione massima intermittente <i>Max intermittent operating pressure</i>	(max 30 s) P2		310	310	310	300	280	260
Pressione massima di picco <i>Max peak pressure</i>	(≤ 0.1 s) P3		320	320	320	310	290	270
Velocità massima intermittente <i>Max intermittent speed</i>	(P ≤ 20 bar) n3	n/min r.p.m.	2700	2700	2700	2700	2700	2700
Velocità massima continua <i>Max continuous speed</i>	(≤ P1) n1		2200	2200	2200	2200	2000	2000
Velocità minima intermittente <i>Min intermittent speed</i>	(≤ P2 x 0.5) (max 30 s) n4		450	450	450	450	450	450

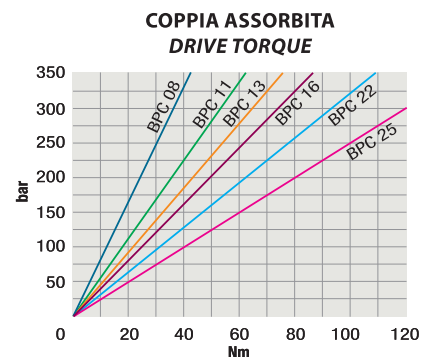
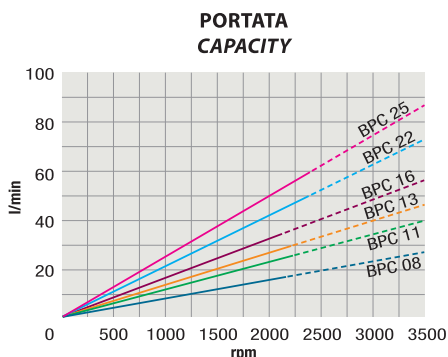
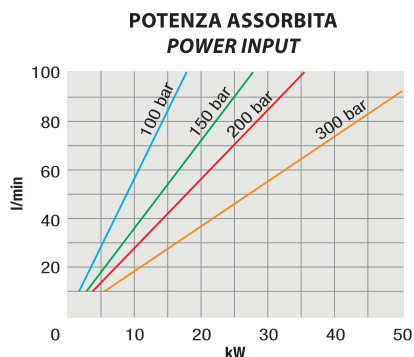
**DIAGRAMMI / DIAGRAMS**

RILIEVI ESEGUITI CON OLIO ISO VG 46 A 50° C ( $\nu = 30 \text{ cSt}$ )  
 THE ABOVE SPECIFICATIONS REFER TO OIL TYPE ISO VG 46 AT 50° C ( $\nu = 30 \text{ cSt}$ )

**ROTAZIONE POMPA / PUMP ROTATION**
